

6	5	4	3	2	1
7	8	9	10	11	12
18	17	16	15	14	13
19	20	21	22	23	24
30	29	28	27	26	25
31	32	33	34	35	36

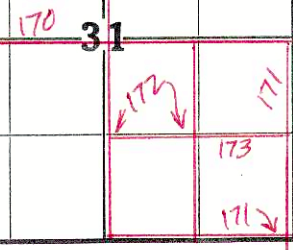
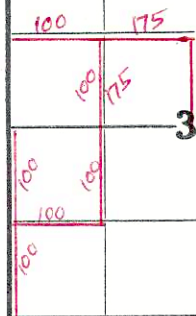

Vol. 1
Vol. 2
Vol. 10

	6	5	4	3	2	1
	7	8	9	10	11	12
	18	17	16	15	14	13
	19	20	21	22	23	24
	30	29	28	27	26	25
	31	32	33	34	35	36

101

174

100
101

Vol. 15
Vol. 1
Vol. 2
Vol. 10

	6	5	4	3	2	1
	7	8	9	10	11	12
	18	17	16	15	14	13
	19	20	21	22	23	24
			122			
	30	29	28	27	26	25
	31	32	33	34	35	36

Vol. 1
Vol. 2
Vol. 10

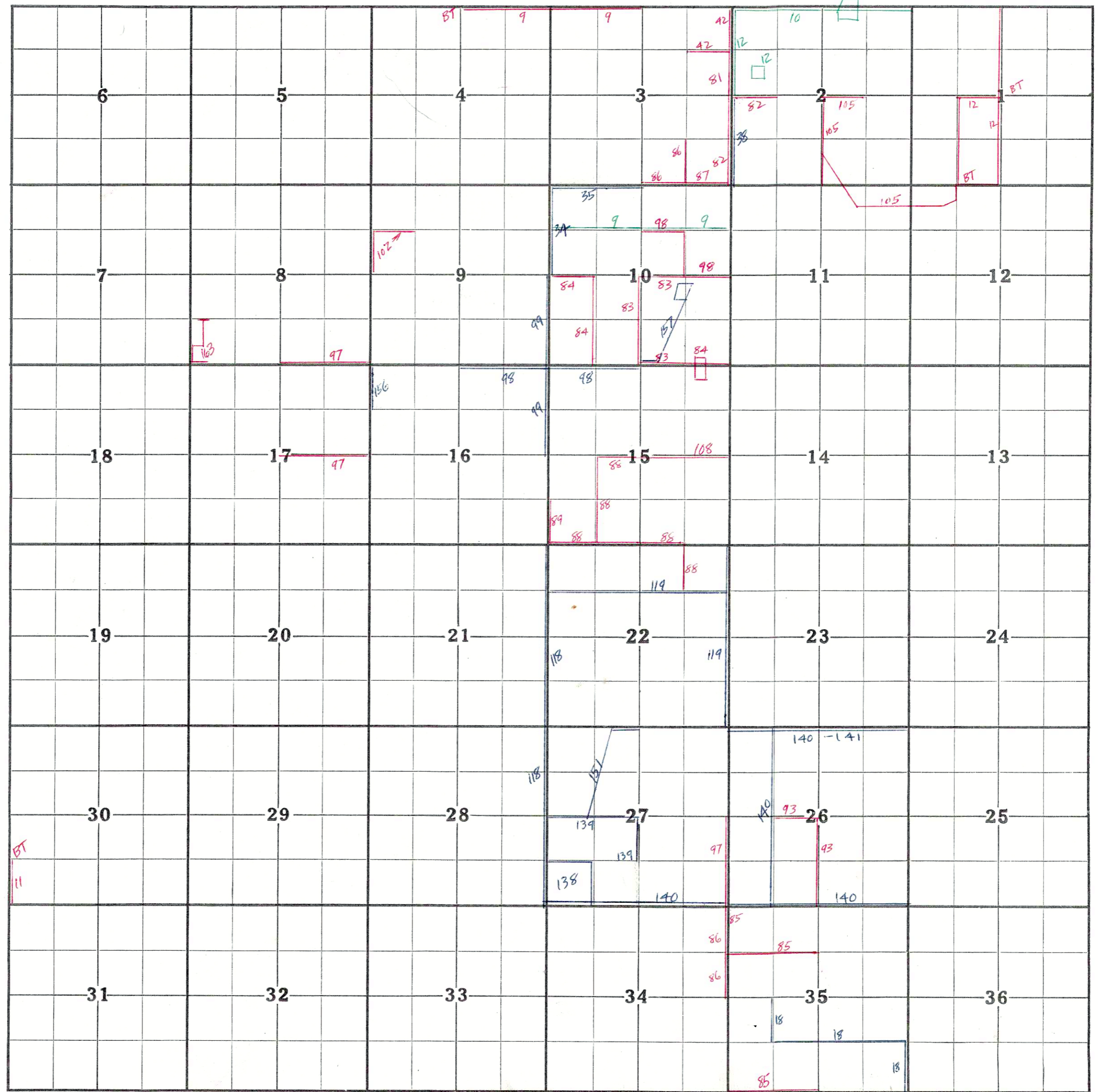

Vol. 1
Vol. 2
Vol. 10

				168		
6	5	4	3	2	1	
7	8	9	10	11	12	
18	17	16	15	14	13	
19	20	21	22	23	24	
30	29	28	27	26	25	
						BT
31	32	33	34	35	36	

	6	5	4	3	2	1	
	7	8	9	10	11	12	
4S _v	18	17	16	15	14	13	27 →
	19	20	21	22	23	24	
	30	29	28	27	26	25	
	31	32	33	34	35	36	

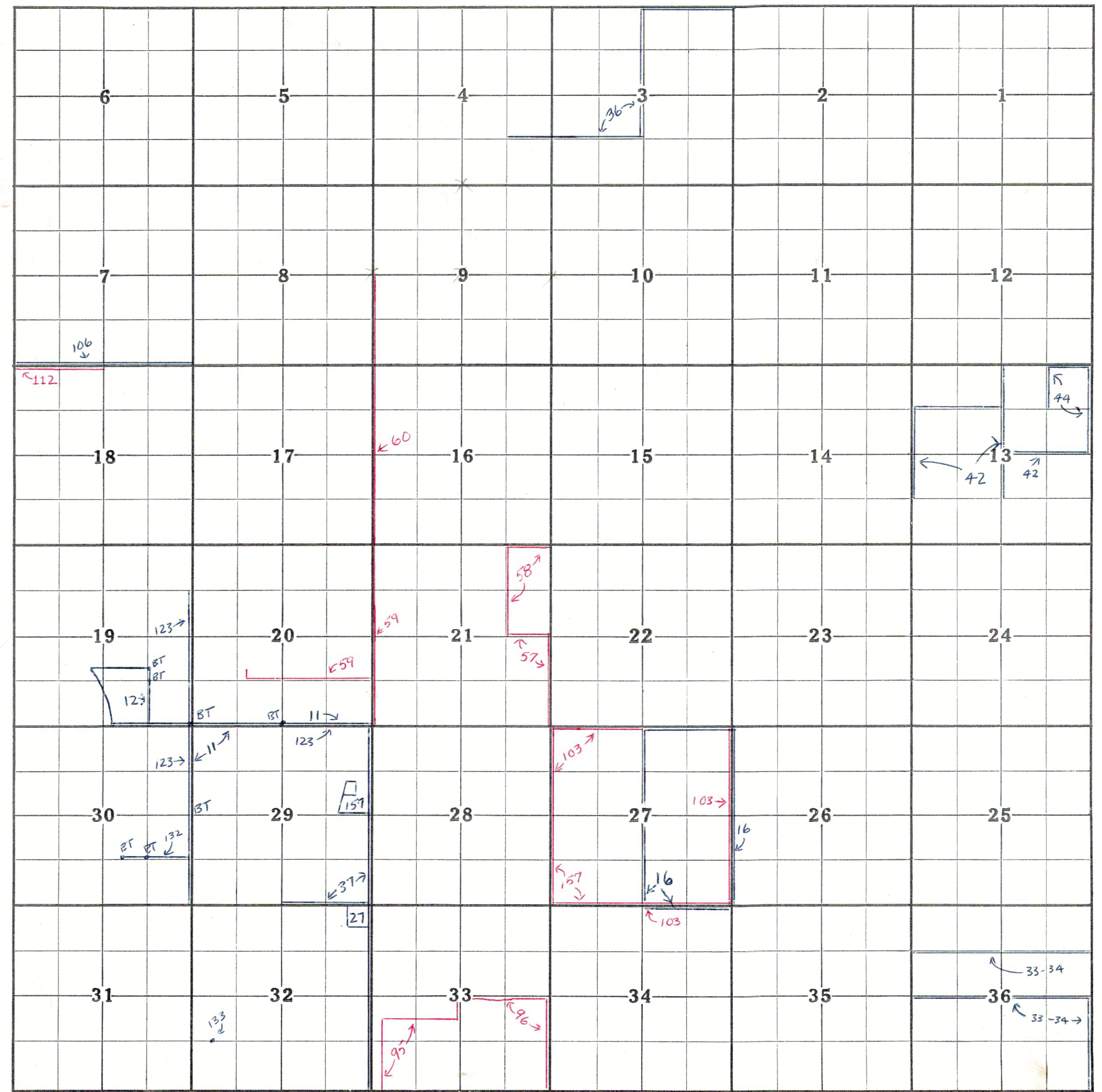

6	5	4	3	2	1	
7	8	9	10	11	12	
18	17	16	15	14	13	
19	20	21	22	23	24	
30	29	28	27	26	25	
31	32	33	34	35	36	



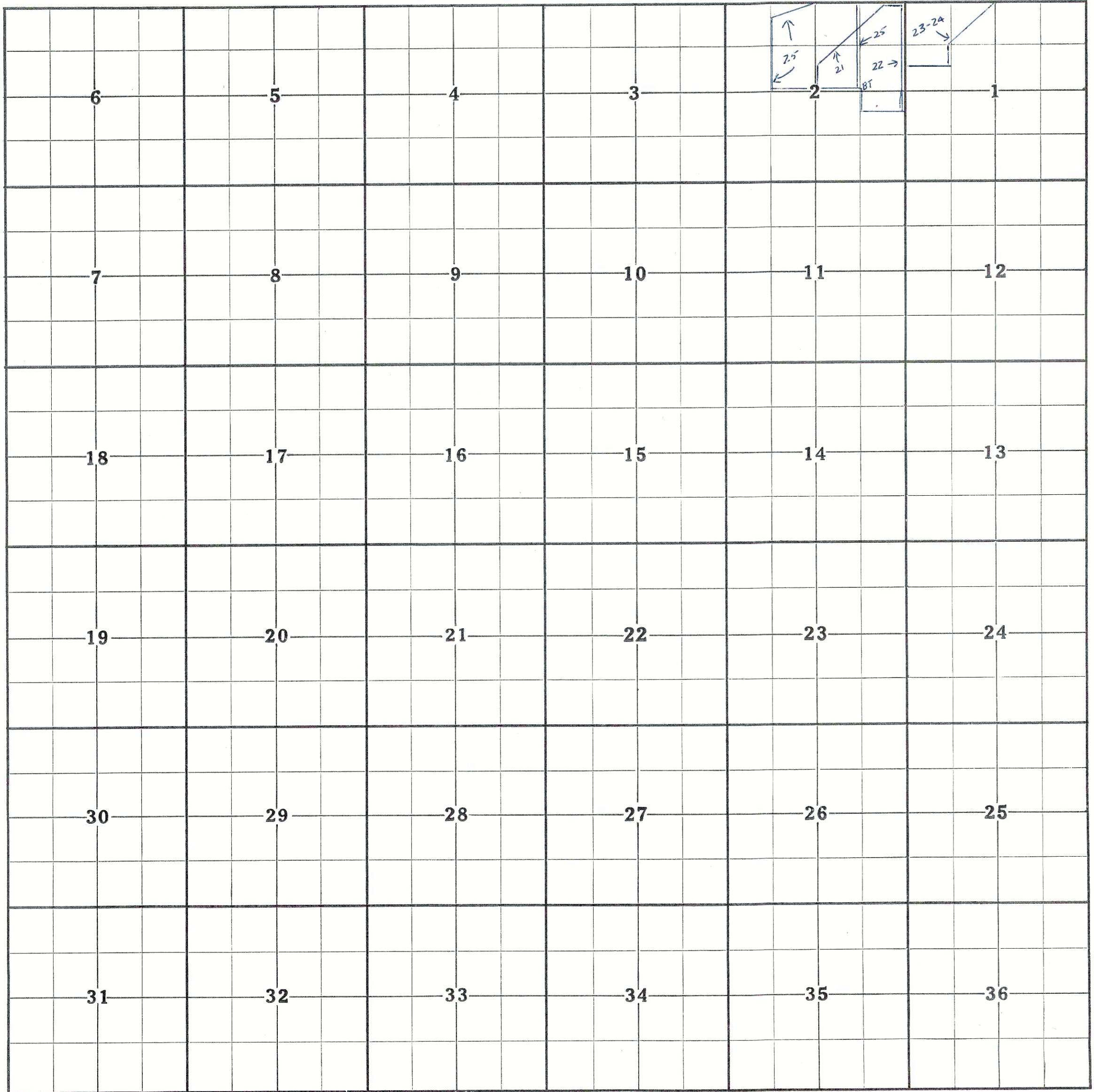

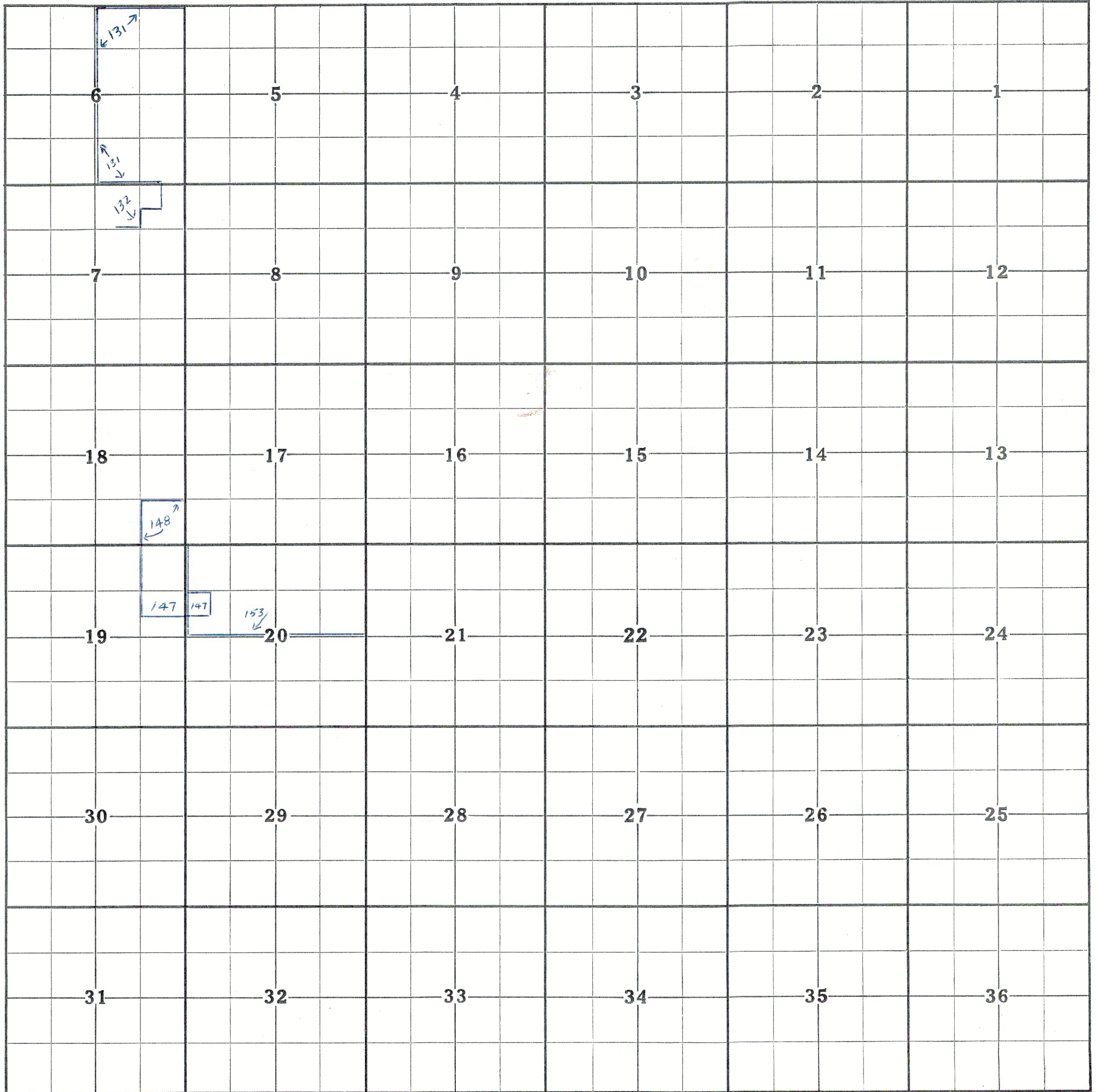

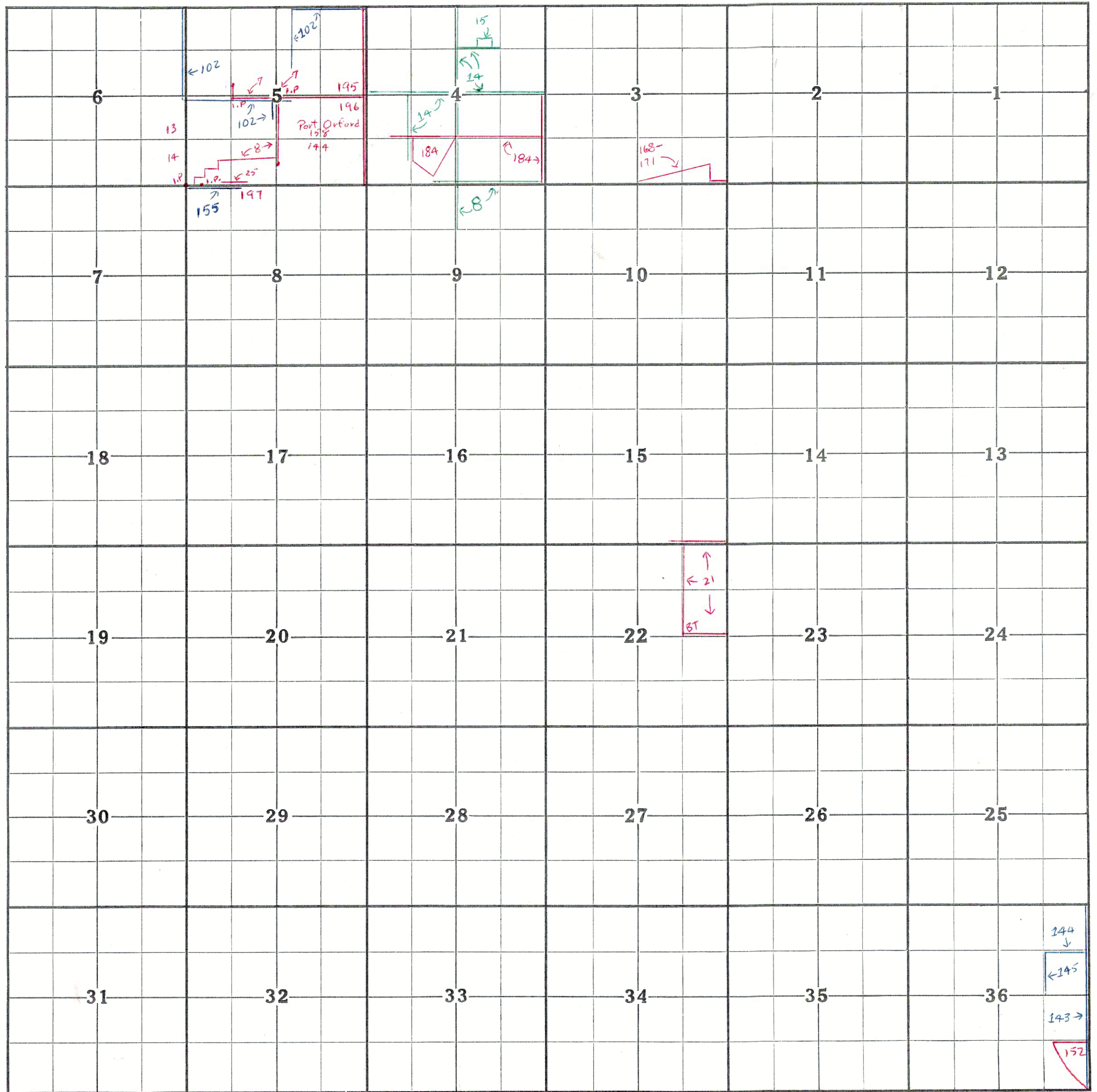

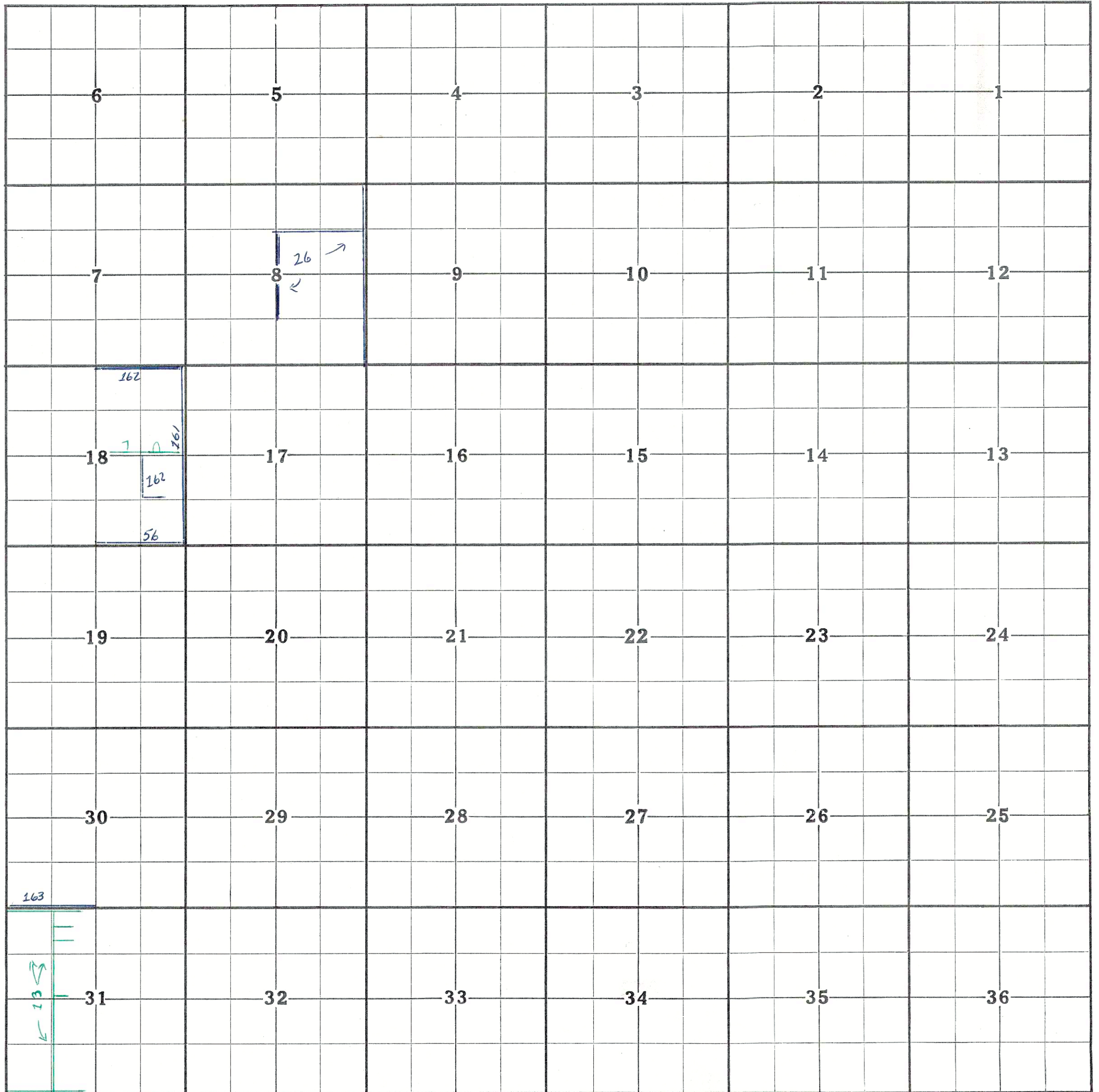

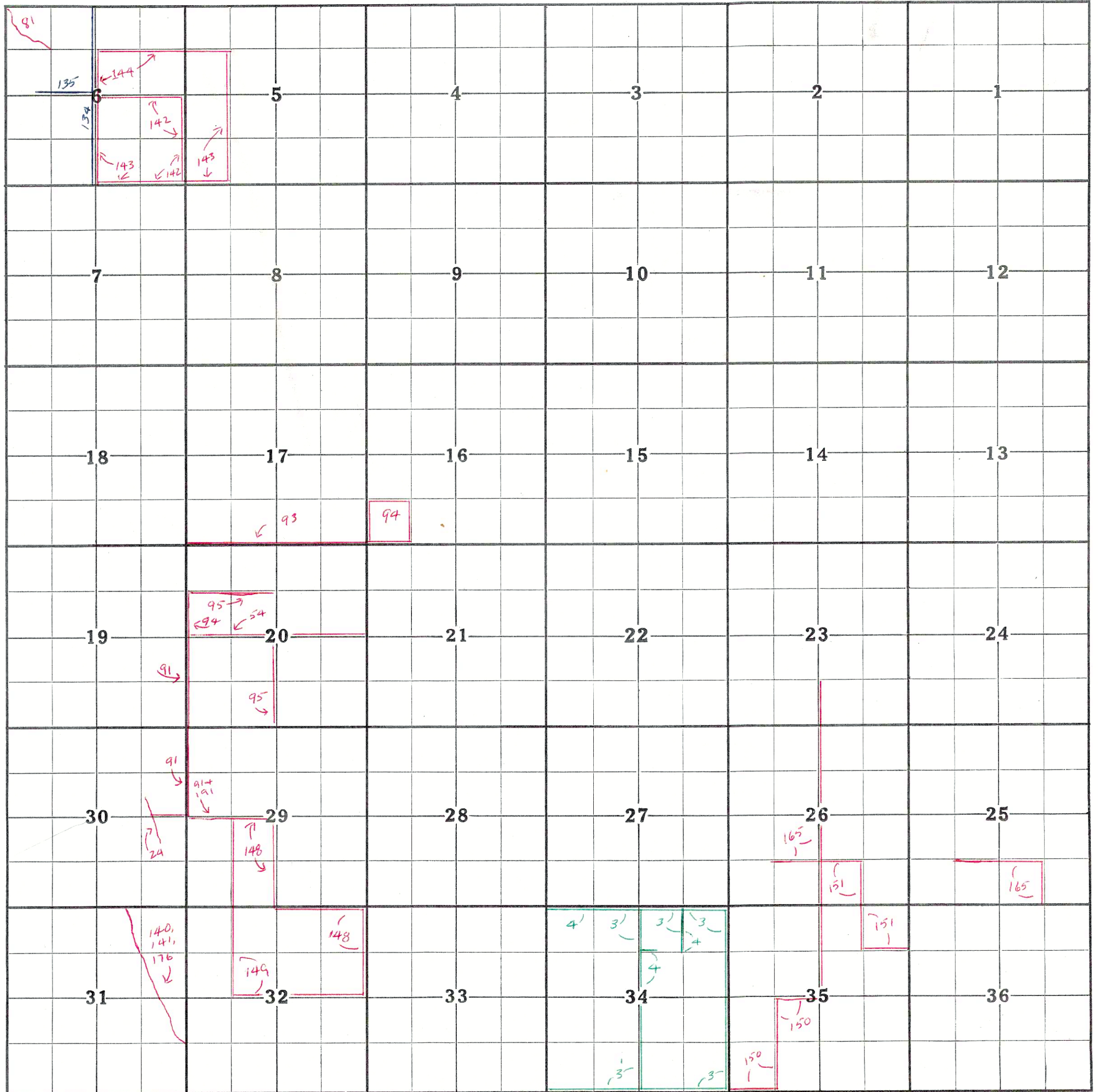

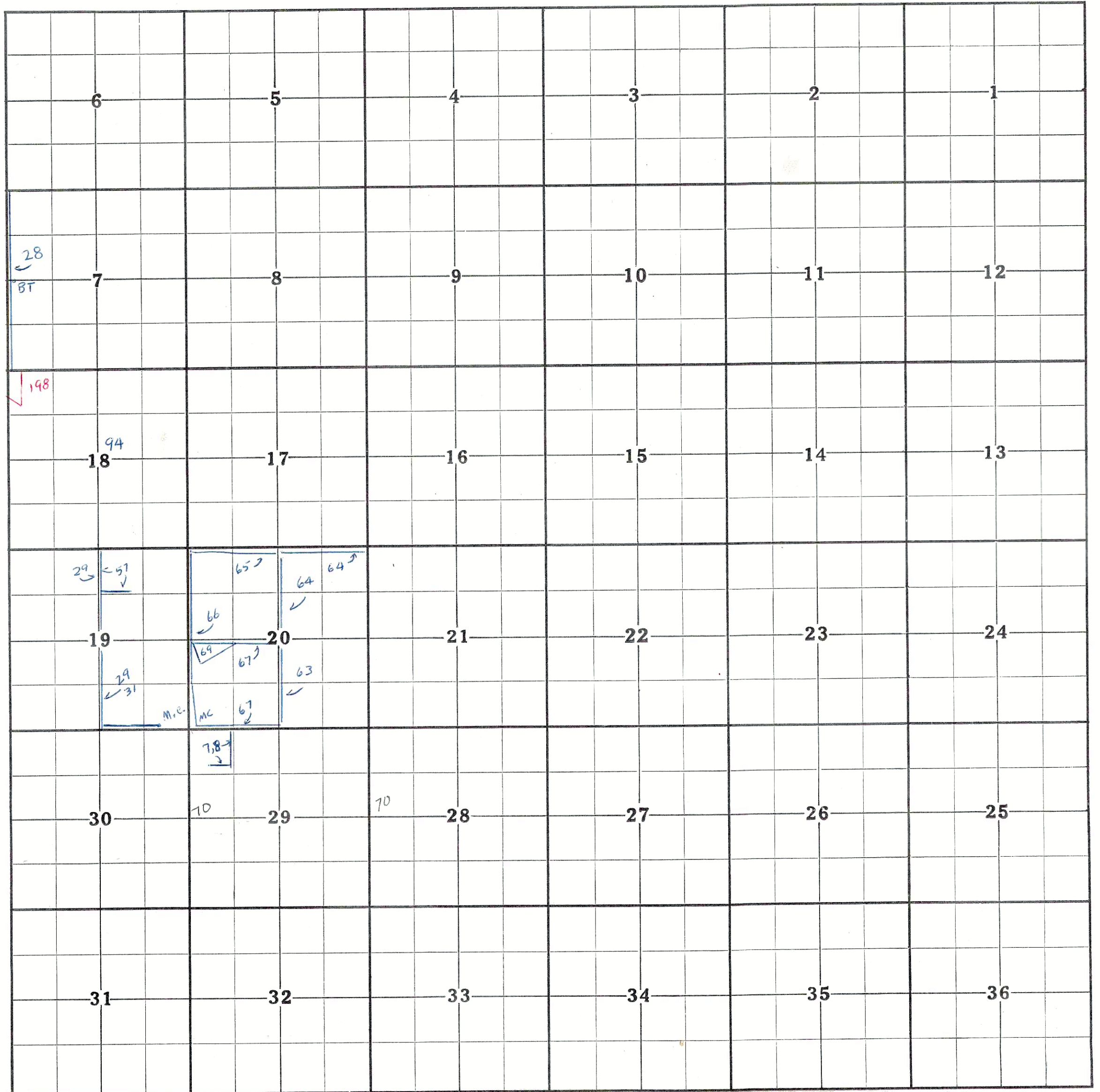

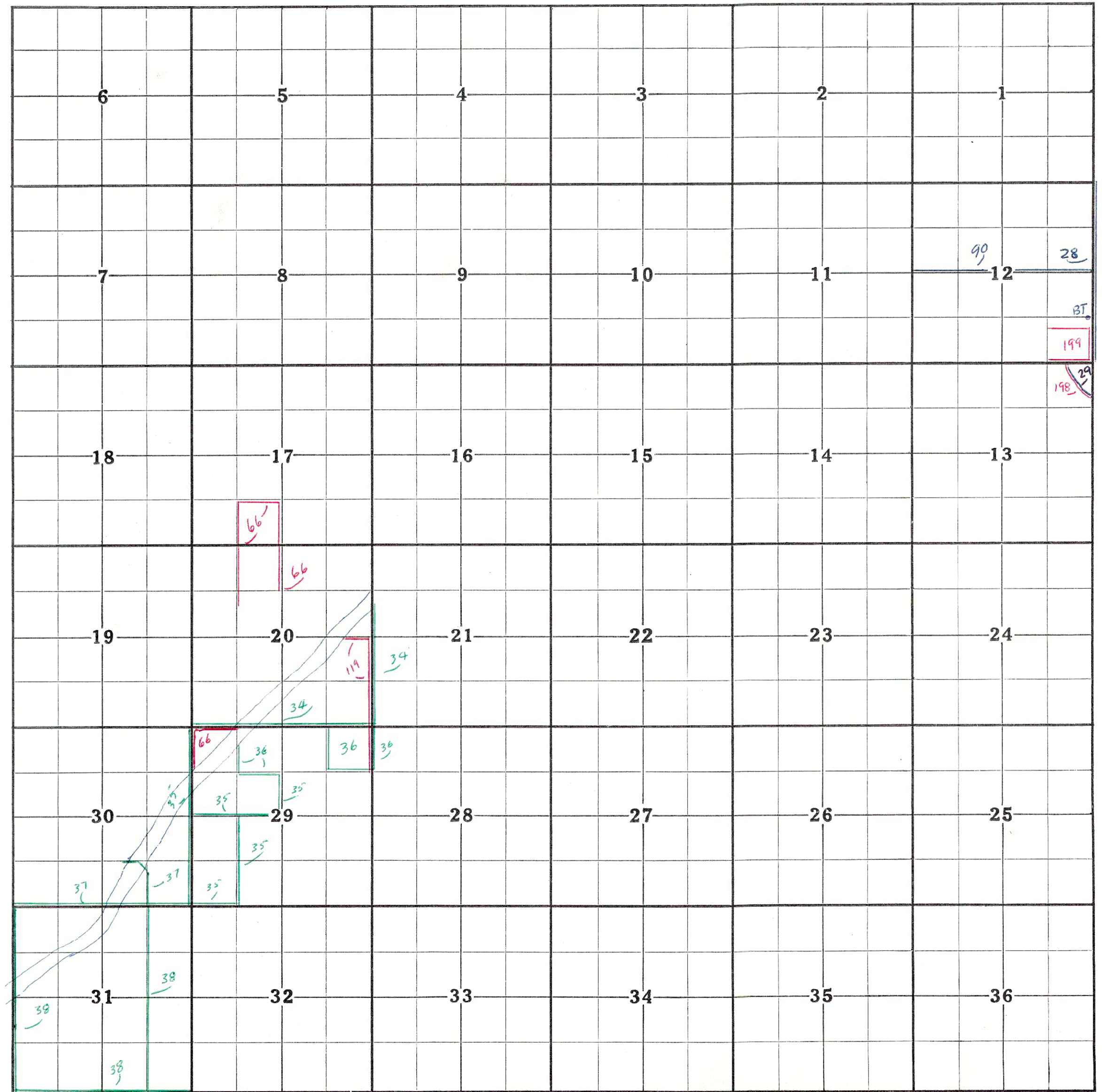

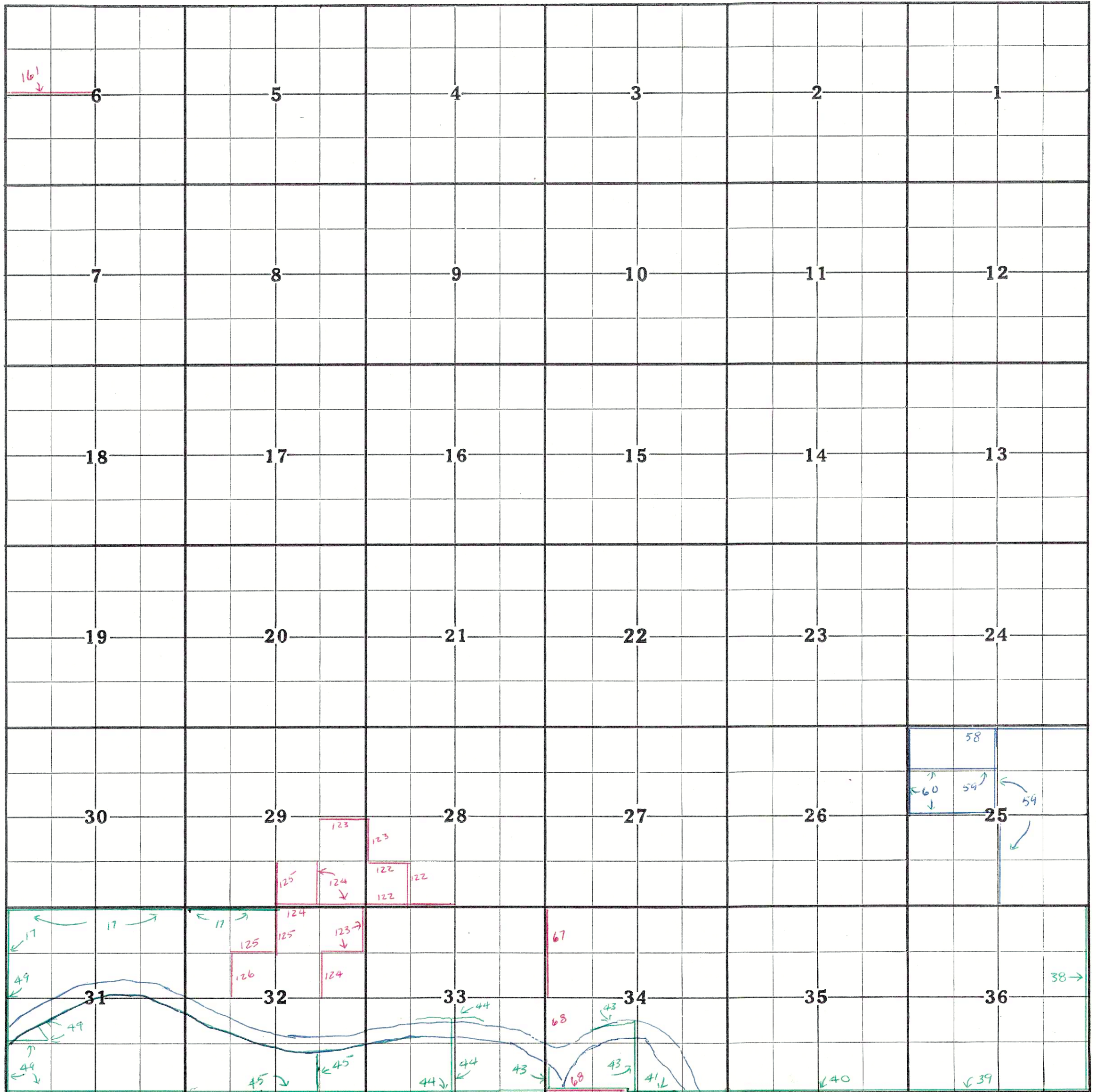

VOL. 1
VOL. 2
VOL. 10

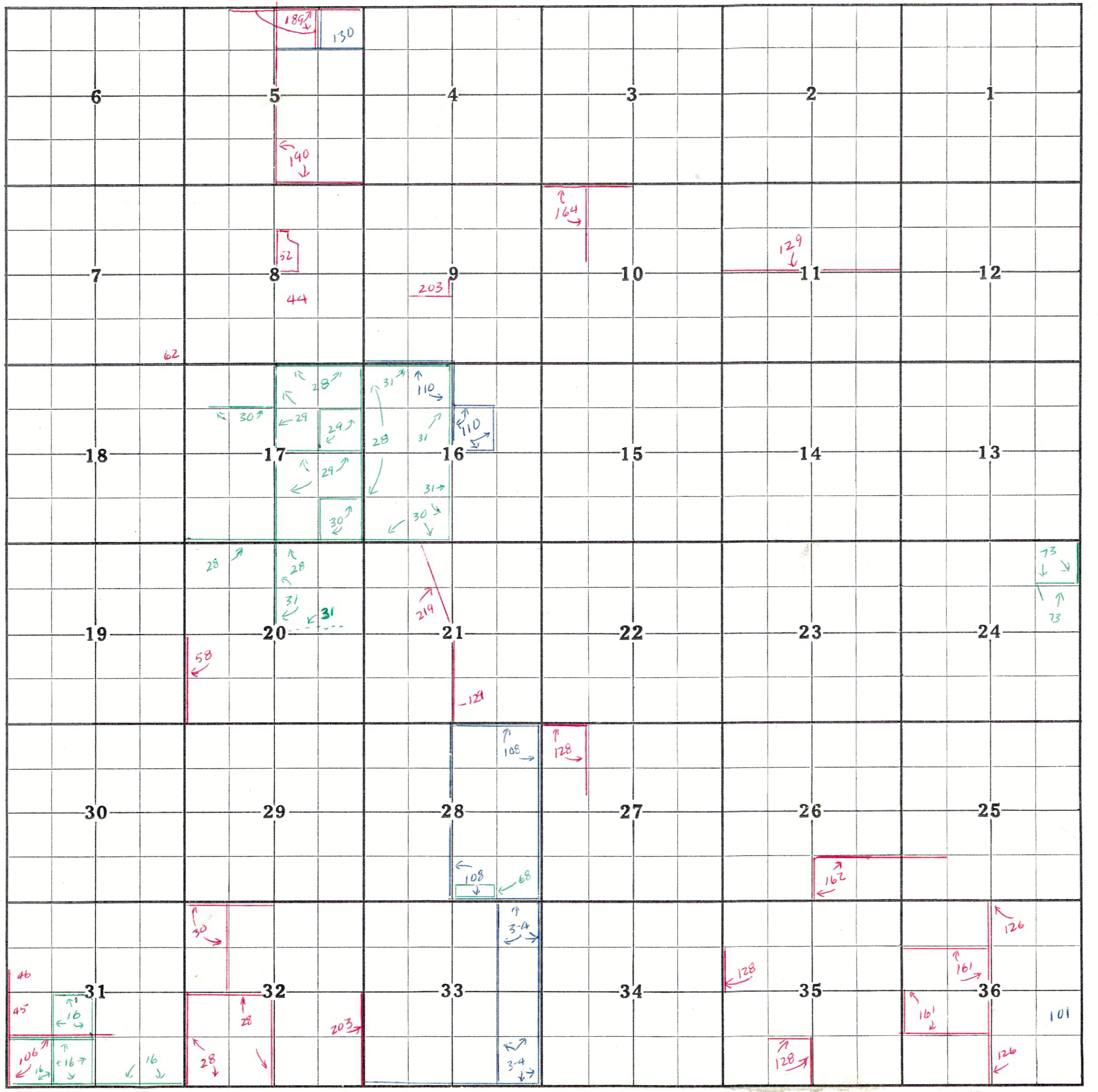

VOL. 1
VOL. 2
VOL. 10

	38 ↗					
6	5	4	3	2	1	
7	8	9	10	11	12	
18	17	16	15	14	13	
19	20	21	22	23	24	
30	29	28	27	26	25	
31	32	33	34	35	36	

VOL. 1
VOL. 2
VOL. 10

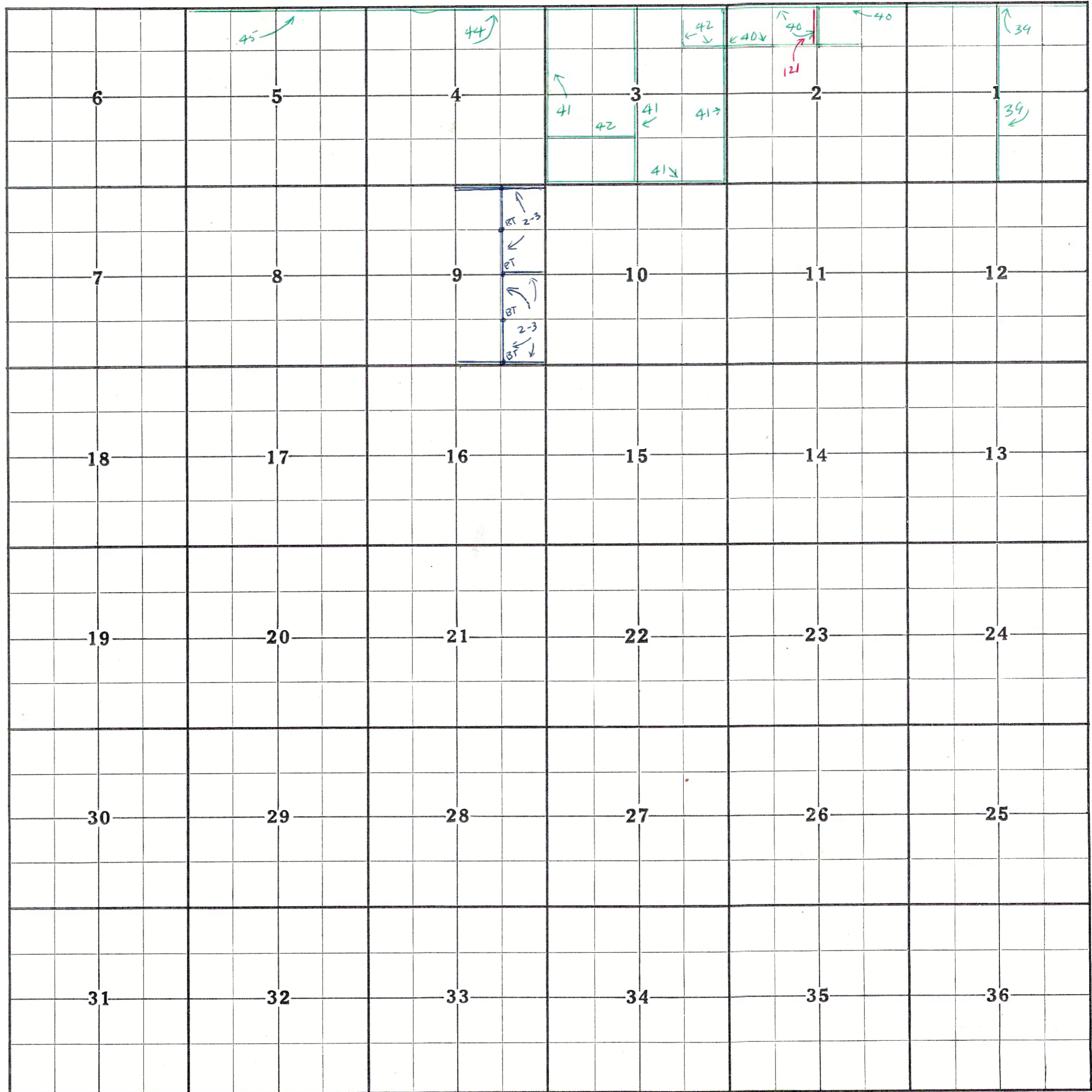

VOL. 1
VOL. 2
VOL. 10

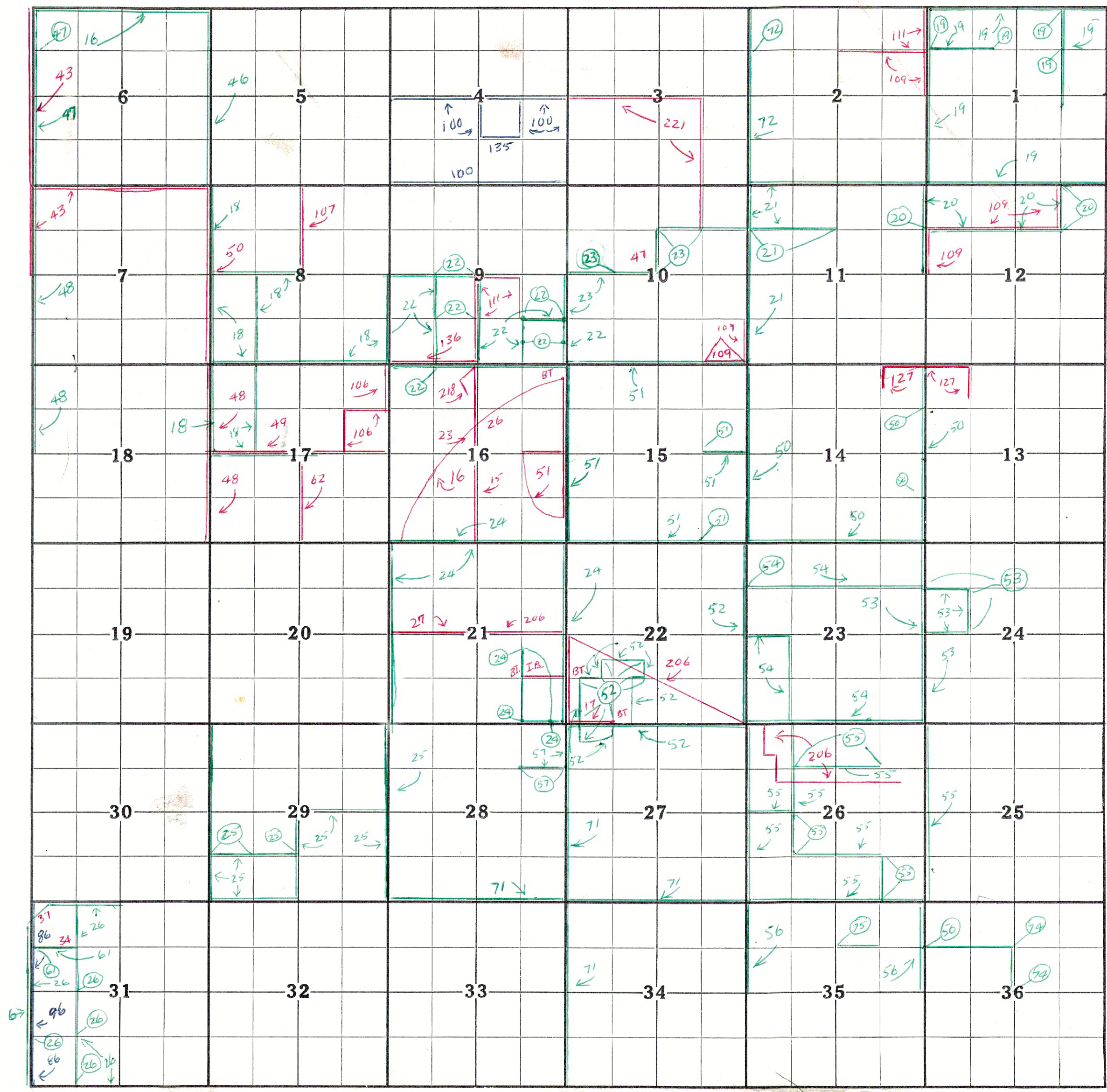

County of Curry

Town 36 S

Range 15 W

VOL. 1
VOL. 2
VOL. 10

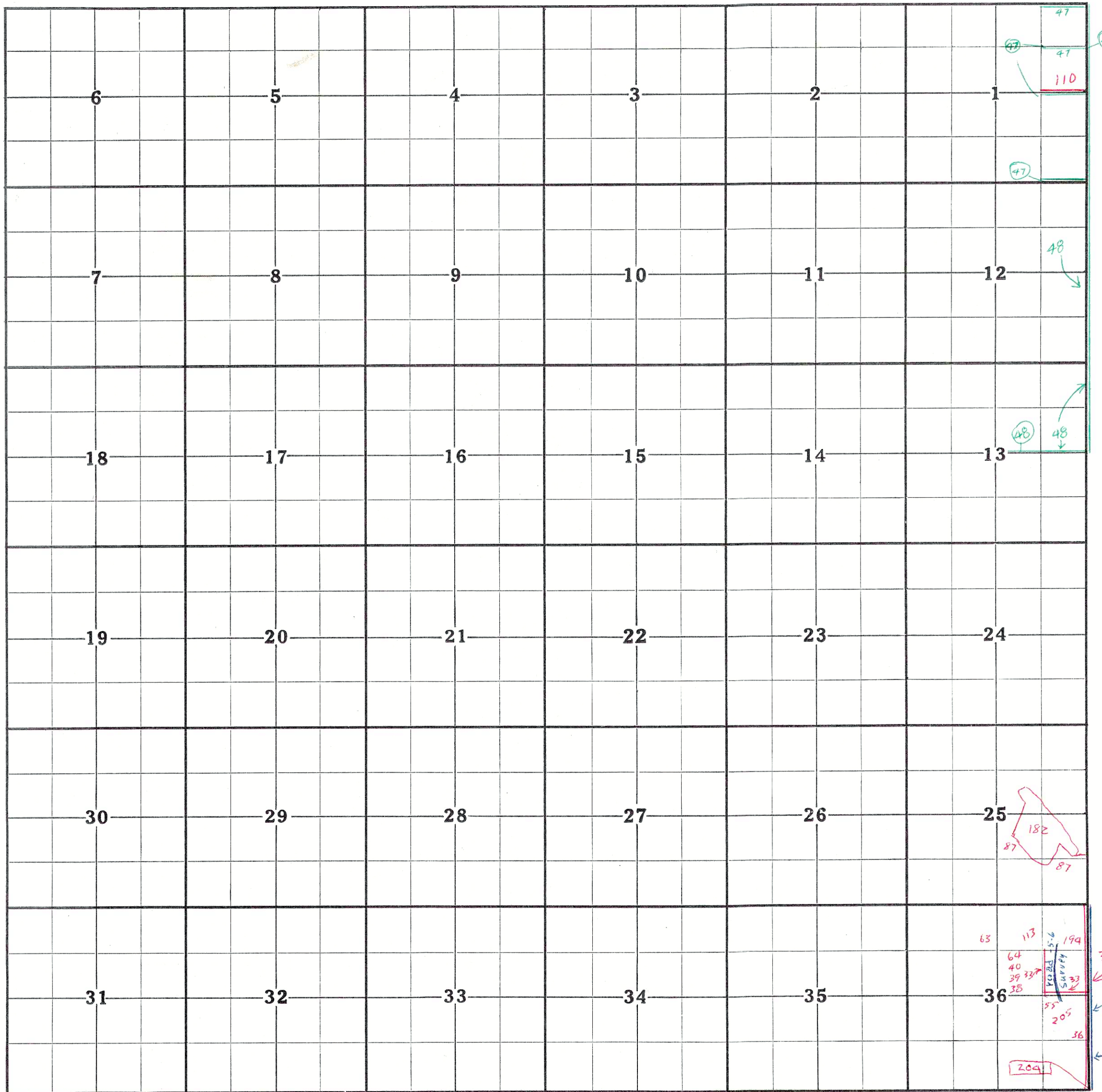

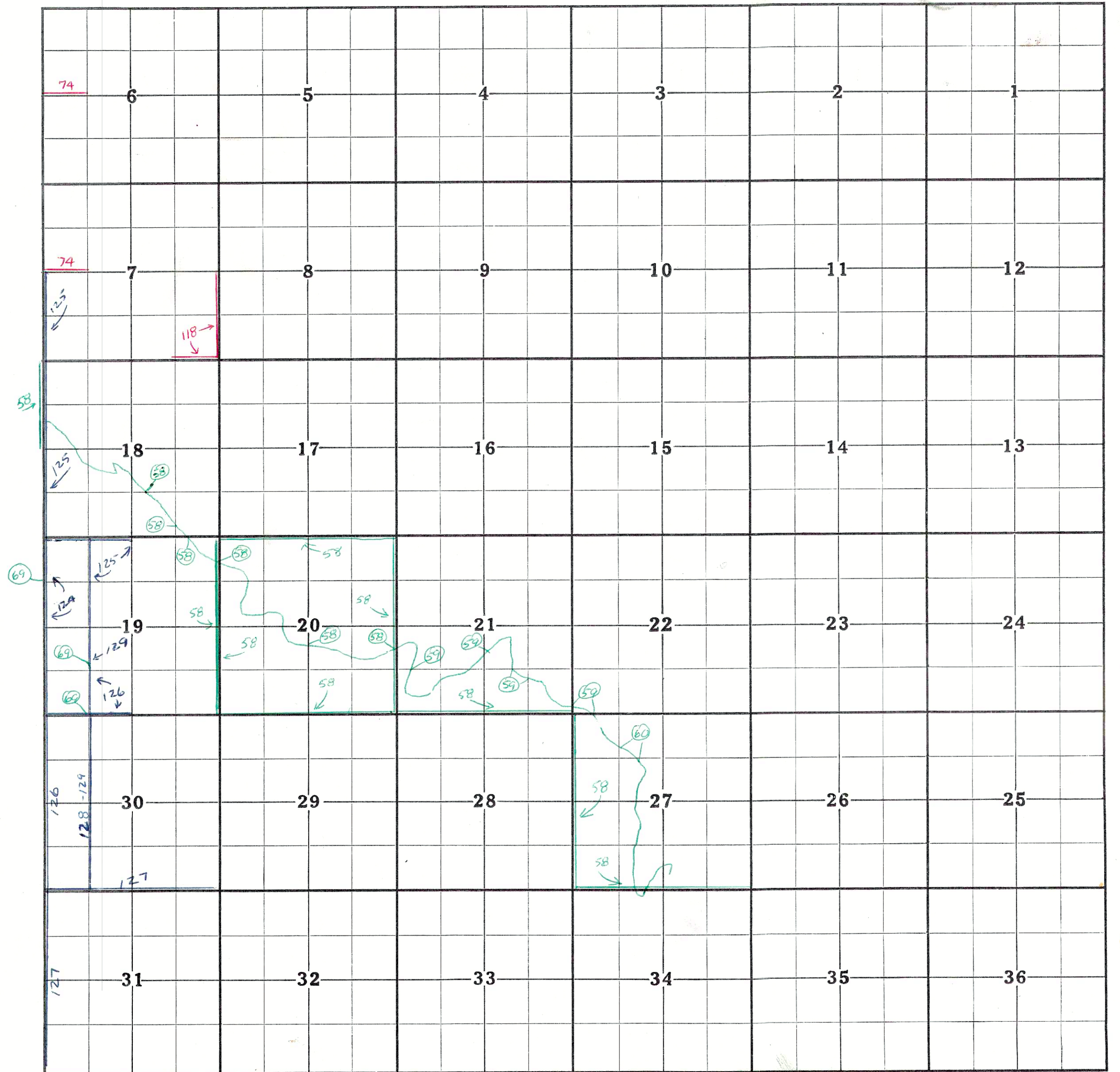

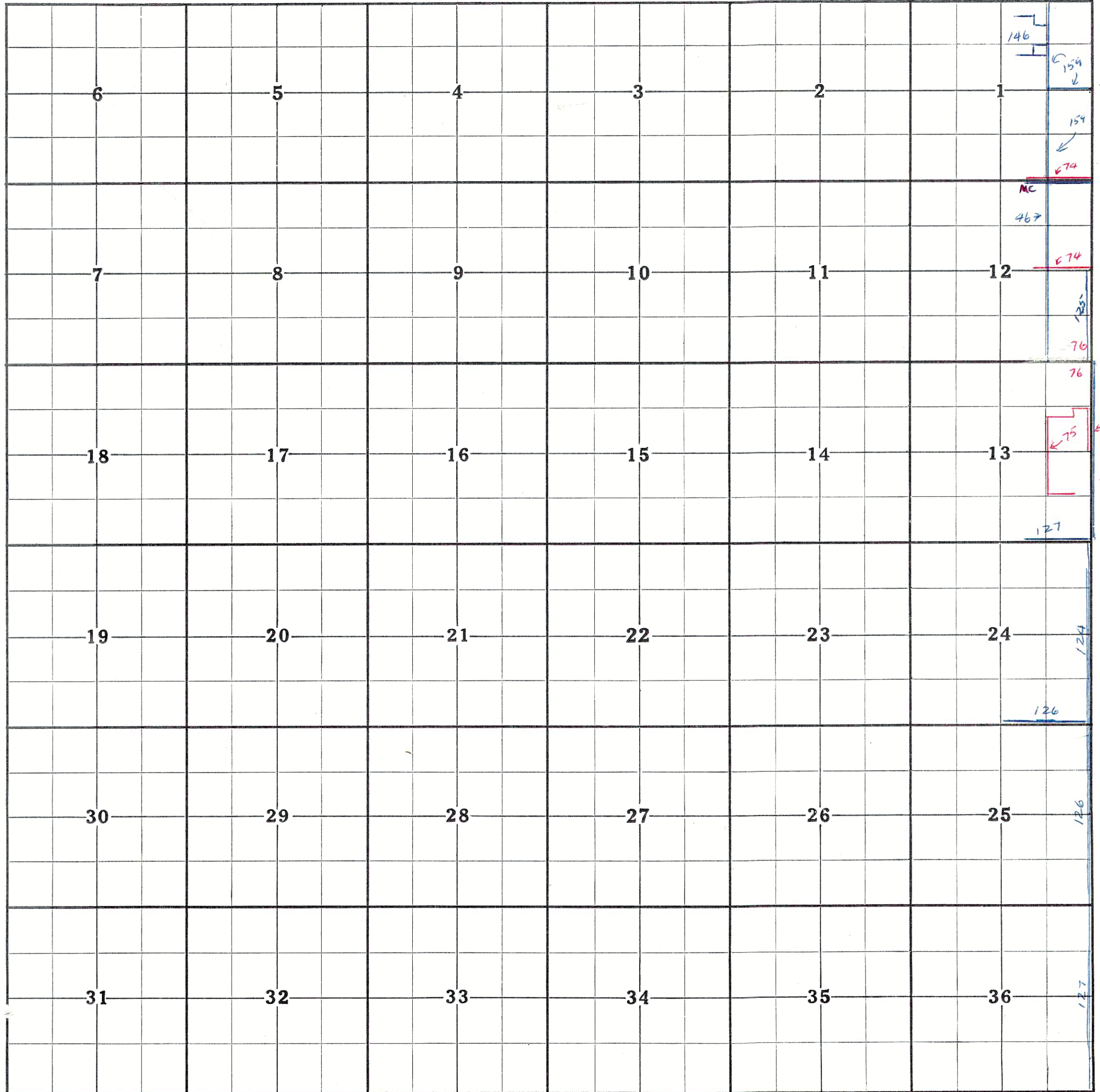

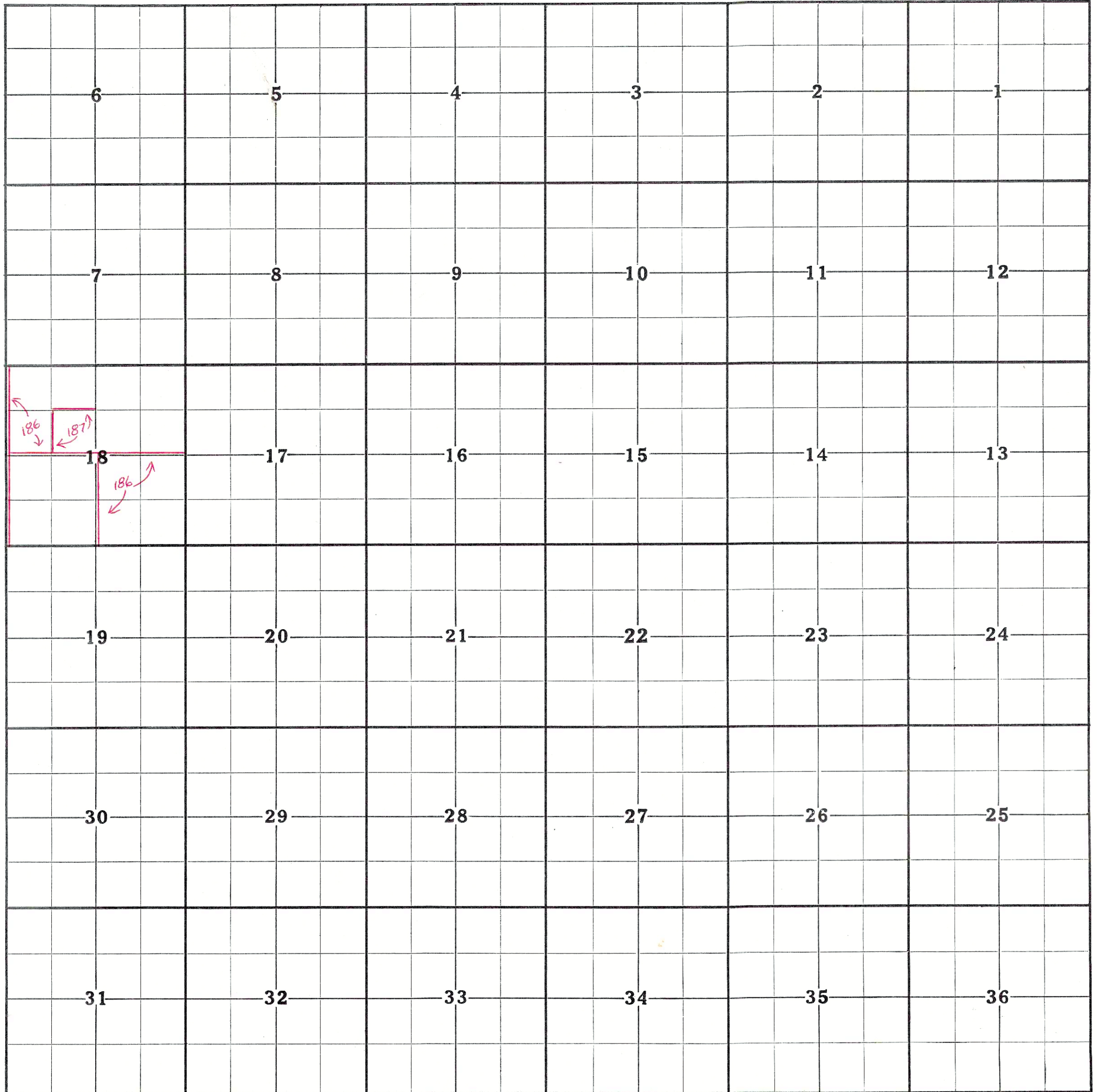

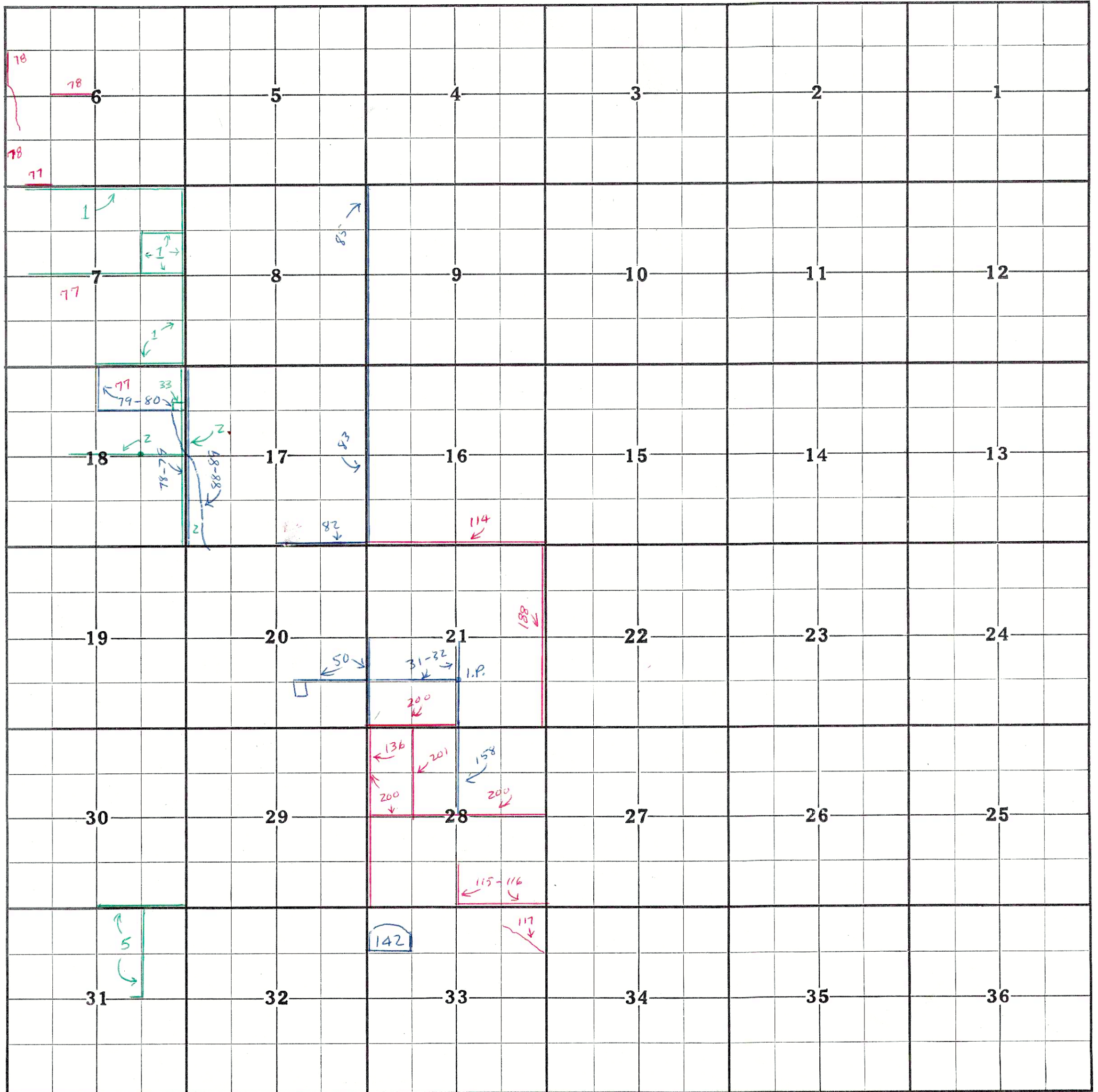

County of Curry

Town 39 S

Range 13 W

Vol. 5 (VOL. 2)

6	5	4	3	2	1
7	8	9	10	11	12
18	17	16	15	14	13
19	20	21	22	23	24
30	29	28	27	26	25
31	32	33	34	35	36

48-49

Vol. 15
VOL. 1
VOL. 2

			75			117				
6		5		4		3		2		1
7		8		9		10		11		12
18		17		16		15		14		13
19		20		21		22		23		24
30		29		28		27		26		25
31		32		33		34		35		36

103
103

County of Curry

Town

40 S

Range

13 W

VOL. 1
VOL. 2
VOL. 10

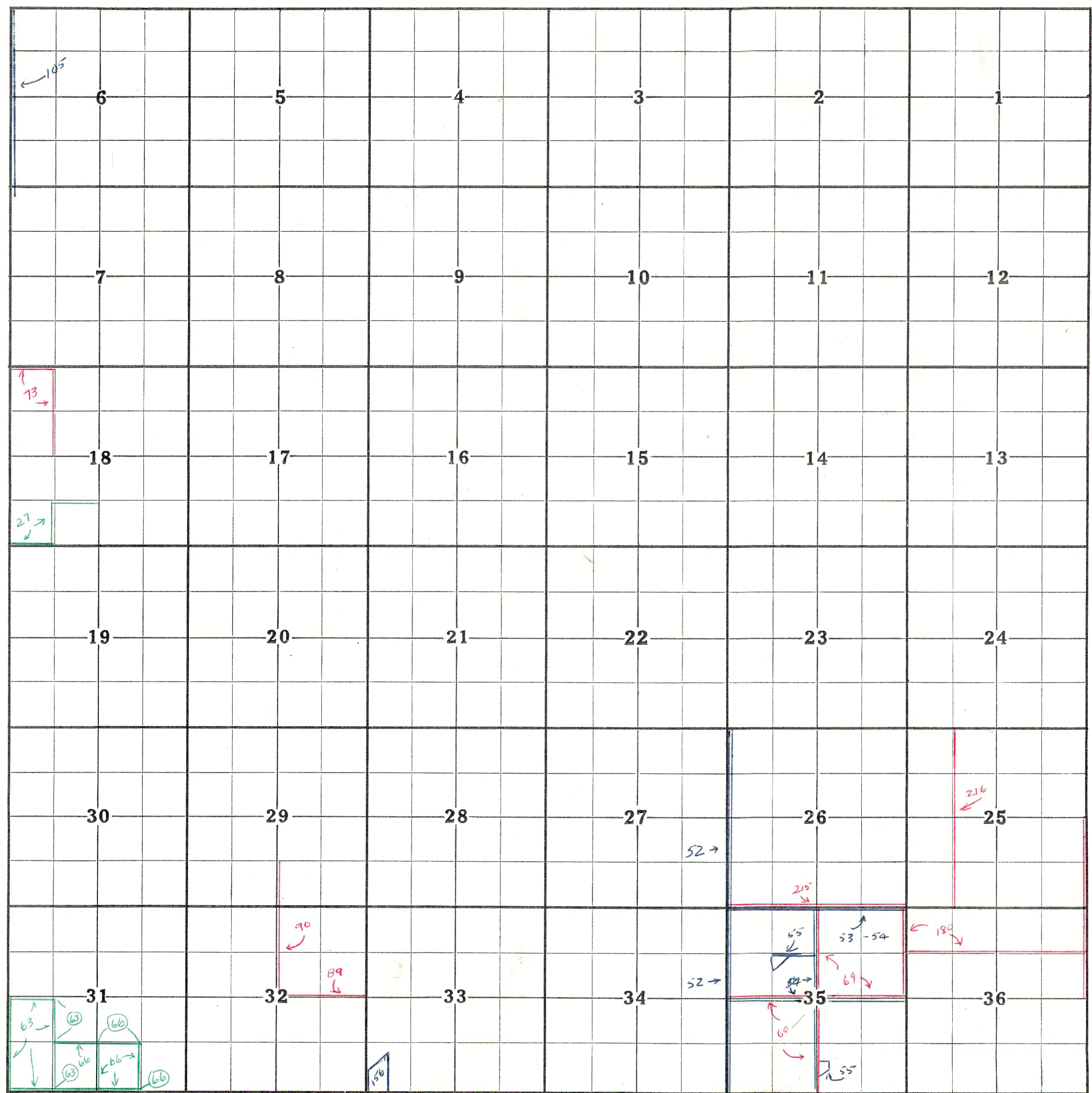

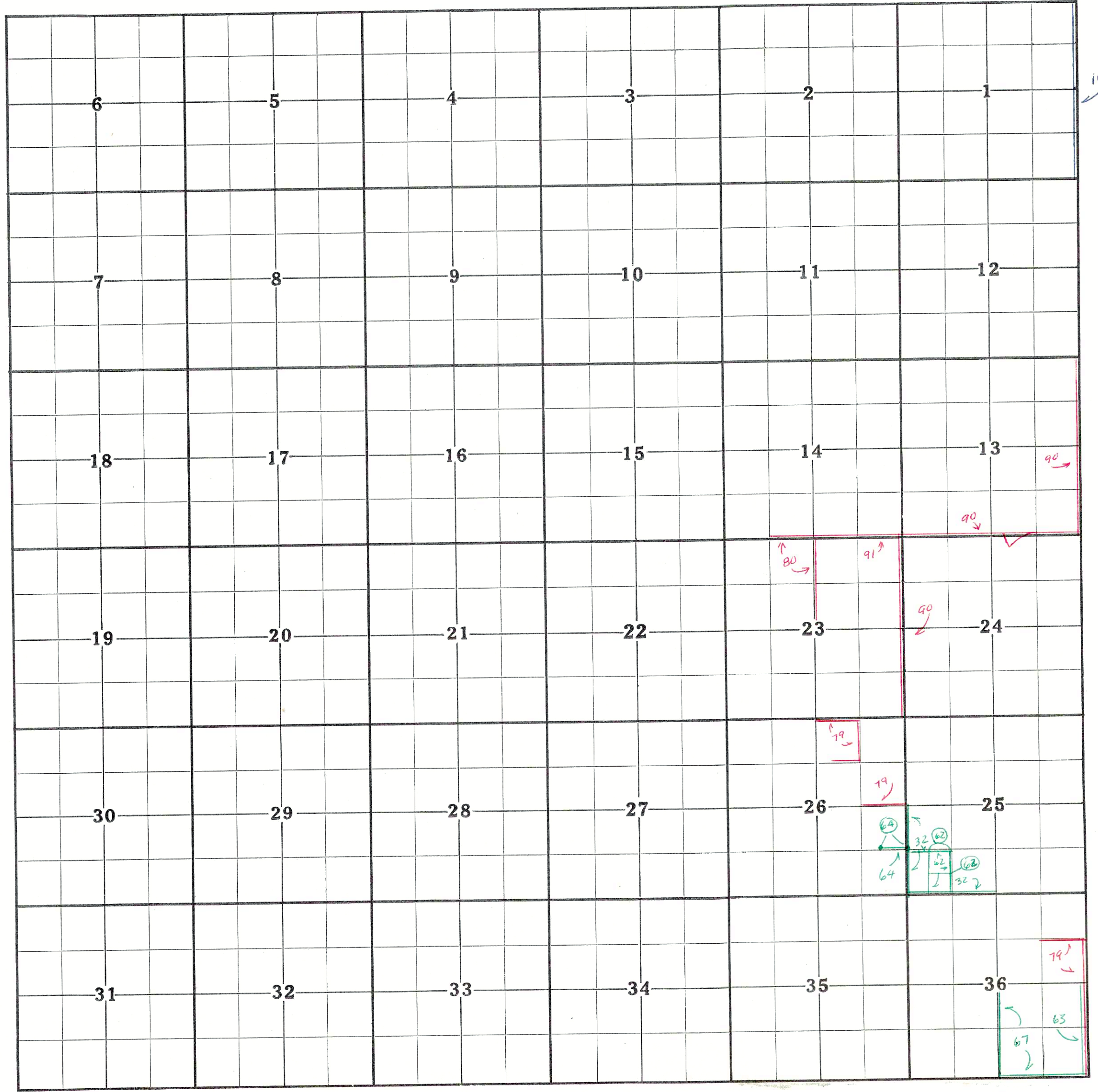

~~Not for Vol. 1
Page 1 of 2
P.L.C. 10-11-00~~

154 ↘												
154 ↘	6 ↗ 154 ↗		5	4	3	2			1			
7	8	134 ↘	9	10	11	12						
18	17		16	15	14	13						
19	20		21	22	23	24						
30	29		28	27	26	25						
31	32		33	34	35	36						

VOL. 15
VOL. 2
VOL. 10

